



INSTALLATION INSTRUCTIONS

AUU-1018-14 Quarter Stall Urinal

- (A) Regular Screwdriver
- (B) Adjustable Wrench
- (C) Marker
- (D) Tape Measure
- (E) Level
- (F) Silicone Sealant
- (G) Drill & Bit
- (H) Thread Sealant
- (I) Hanger Clip (Included)
- (J) 2" NPT Outlet Spud (Included)
- (K) Flush Valve (Sold Separately, Not Included)

Recommended Tools & Materials

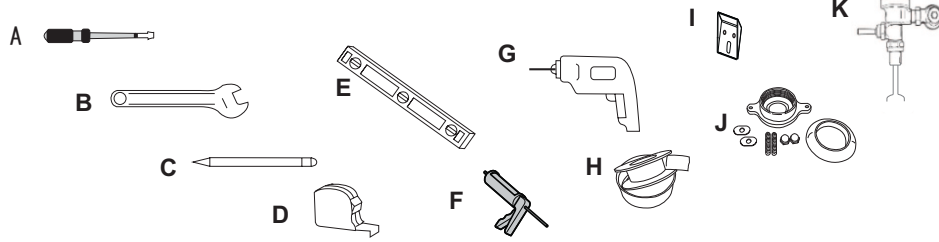

CAUTION: PRODUCT IS FRAGILE

Handle with care to avoid breakage and possible injury!

Note: Views in this illustrations are for general representation and may not necessarily define the exact contours of the product.

Refer to local plumbing and building codes as well as the manufacture's instructions for the flush valve requirements.

The dimensions of the fixture are nominal and conform to tolerances as outlined in the ASME Standard A112.19.2.

Quarter Stall Urinal Bowl Installation

Model: AUU-1018-14

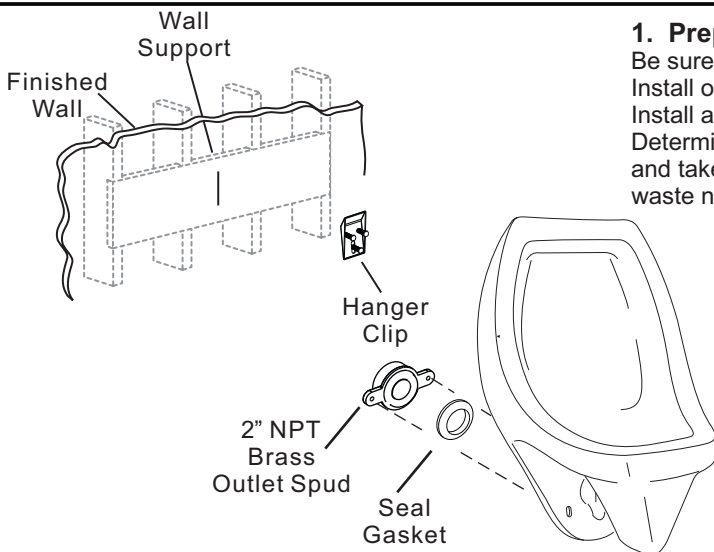
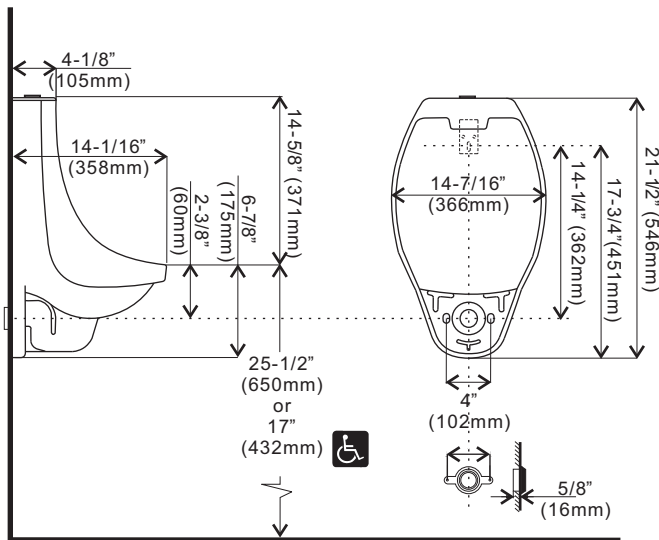

1. Preparation

Be sure to turn off water supply before starting.

Install or relocate the supply and waste pipe to match the rough-in dimensions.

Install adequate wall support in the general location of the wall hangers.

Determine the location of the waste pipe nipple as well as the length of the nipple and take into account for the brass outlet spud (included) that threads into the waste nipple. Also consider the spacing for the gasket.

CAUTION PRODUCT IS FRAGILE

Handle with care to avoid breakage and possible injury!

2. Installation

Install the hanger clip according to the rough-in dimensions placing one anchor screw into the slotted vertical hole.

Apply pipe thread sealant tape to the waste pipe nipple and install the brass outlet spud to the waste pipe nipple.

Place the seal gasket on the brass outlet spud collar with the beveled side of the gasket facing away from the wall.



AUU-1018-14
Rev. 4/16



INSTALLATION INSTRUCTIONS

AUU-1018-14 Quarter Stall Urinal

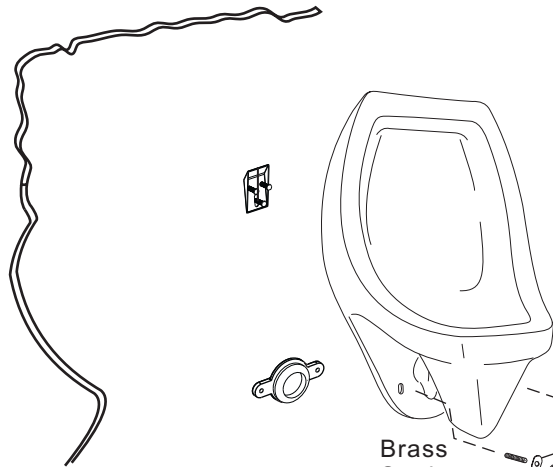

3. Setting the Urinal

Dry fit the urinal to the hanger and check for alignment with the outlet. If necessary, adjust the hanger clip up or down so the attachment holes of the urinal match the attachment holes on the brass outlet spud. Once aligned properly, thread the brass studs into the outlet spud a minimum of 1/4". Remove the urinal and permanently fasten the hanger clip to the wall with two additional anchor screws in the round hanger clip holes.

4. Permanently fixing the urinal to the wall

Re-set the urinal on the hanger and align the brass fastening studs through the attachment holes of the urinal. Level the urinal and place the SS washers and cap nuts onto the brass studs and snug tight with a wrench.

▲ CAUTION: PRODUCT IS FRAGILE

Risk of product damage from over tightening the cap nuts.

5. Complete the Installation

Flush Debris from the supply line if necessary before attaching flush valve.
Install the flush valve according to the manufacturer's instructions.

Connect the water supply and complete the waste pipe connections if necessary.

Turn the water supply ON.

Carefully check supply for leaks.

Flush the urinal and monitor both the supply and waste pipes for leaks.

After being sure that there are no leaks, use sealant to caulk between the wall and the urinal back.

Care and Maintenance

When cleaning your fixtures, wash it with mild, soapy water, rinse thoroughly with clear water and dry with a soft cloth.

Avoid detergents, disinfectants, or cleaning products in aerosol cans.

NEVER use abrasive scouring powders or abrasive pads on your fixture. Some bathroom chemicals and cosmetics may damage the fixture finish.

Caution: Product is Fragile.

To avoid breakage and possible injury handle with care!

One (1) Year Limited Warranty

AMTC warrants its vitreous china to be free of defects in material and workmanship for a period of one (1) year from date of purchase, when properly installed and under normal use and service. A defective product may be returned to AMTC, or its authorized representatives, within one (1) year from date of purchase with the proper invoice of purchase. AMTC, at its discretion, will replace or repair defective product at no charge. Claims for labor, transportation, and any other incidental costs will not be allowed. AMTC will not be responsible for any considerable damages of any kind whatsoever.

For Technical Support:
Call Toll Free: 800-874-7822
Email: technicalsupport@AMTcorporation.com
Web: www.AMTCorporation.com

Make sure to visit our website periodically for information on new products and to download any important documents that you may need in the future.



Advanced Modern Technologies Corporation
19800 Nordhoff Place, Chatsworth, CA 91311 USA
Toll Free Tel: 800-874-7822 • Tel: 818-883-2682 • Fax: 818-883-2620
sales@AMTCorporation.com • www.AMTCorporation.com

AUU-1018-14
Rev. 4/16