



# HYBRIDFLUSH® TOP MOUNT

AUTOMATIC CONCEALED RETROFIT FOR WATER CLOSETS (TOILETS)

Model  
AEF-801-WBCRT

## Description

Hardwired, Sensor Operated HYBRIDFLUSH® Top Mount Retrofit Conversion Kit for Wall Box Concealed Water Closet (Toilet) Flushometers.

## Flush Cycle

- ☐ Model AEF-801-WBCRT-11 (1.1 gpf/4.2 Lpf)
- ☐ Model AEF-801-WBCRT-12 (1.28 gpf/4.8 Lpf)
- ☐ Model AEF-801-WBCRT-16 (1.6 gpf/6.0 Lpf)
- ☐ Model AEF-801-WBCRT-35 (3.5 gpf/13.2 Lpf)

## Features

- Patented BRV® and Gear Motor Drive
- Wall Box Plate with Sensor
- Hands Free Infrared Sensor Activation
- Vandal and Water Resistant Design
- Chrome Plated All Metal Housing
- Quiet Operation
- Electronic Flush Button
- Operates on 6-Volt DC Power (Transformer Sold Separately)
- Adjustable Sensor Distance
- Optional Three (3) Second Flush Delay Mode
- Optional 24-Hour Flush Mode
- Uses Proprietary Silicone Diaphragm with Filtered Bypass

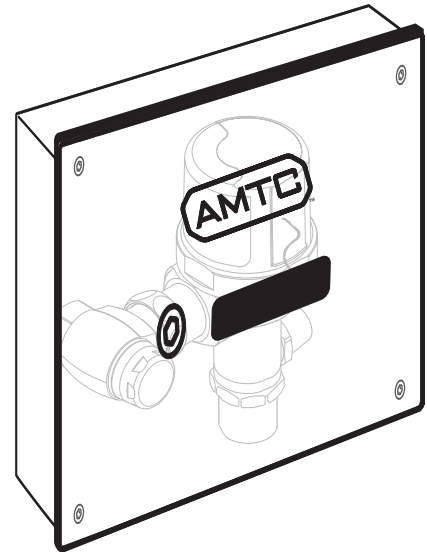

\*AEF-801-WBCRT unit includes a Valve Body.  
It does NOT include Supply Stop or Tailpiece.

## The HYBRIDFLUSH® Advantage

The **HYBRIDFLUSH®** is a revolutionary full-featured automatic flush valve. The **HYBRIDFLUSH®** incorporates a unique patented mechanism that allows for unsurpassed reliability. The **HYBRIDFLUSH®** by Advanced Modern Technologies Corporation is the most efficient, economical, and complete automatic flush valve system on the market.

## Accessories (Add suffix to model number for accessories)

- ☐ AMTCTRANS6VDC - 6-Volt AC/DC Transformer

**Warranty**  
5 Years

**AXIO®**  
TOUCH-FREE TECHNOLOGY

  
**ADA Compliant**

For Finish Variations Please Consult Factory

### Architect/Engineer Approval

|                      |       |
|----------------------|-------|
| Job Name             | _____ |
| Date                 | _____ |
| Model Specified      | _____ |
| Quantity             | _____ |
| Variations Specified | _____ |
| Customer/Wholesaler  | _____ |
| Contractor           | _____ |
| Architect            | _____ |

The information contained in this document is subject to change without notice.  
Revision (02/19)



# HYBRIDFLUSH® TOP MOUNT

AUTOMATIC CONCEALED RETROFIT FOR WATER CLOSETS (TOILETS)

Model  
AEF-801-WBCRT

## Specifications:

|                                  |  |
|----------------------------------|--|
| <b>Operation:</b>                | <b>Automatic</b>                           |
| <b>Outer Casing:</b>             | <b>Standard-Chrome Metal</b>               |
| <b>Operating Water Pressure:</b> | <b>15 PSI - 100 PSI</b>                    |
| <b>Sensor Type:</b>              | <b>Infrared</b>                            |
| <b>Power Type:</b>               | <b>6-Volt DC Power</b>                     |
| <b>Arming Delay:</b>             | <b>5 Seconds</b>                           |
| <b>Flush Delay:</b>              | <b>3 Seconds</b>                           |
| <b>Sensing Range:</b>            | <b>18" (45cm) - 30" (75cm) Adjustable</b>  |
| <b>Ghost Flush:</b>              | <b>Once every 24 Hours From Last Flush</b> |
| <b>Sensor Angle:</b>             | <b>Fixed Angle</b>                         |
| <b>Flush Cycle:</b>              | <b>Specified by Model</b>                  |
| <b>Model AEF-801-WBCRT-11</b>    | <b>1.1 gpf/4.2 Lpf</b>                     |
| <b>Model AEF-801-WBCRT-12</b>    | <b>1.28 gpf/4.8 Lpf</b>                    |
| <b>Model AEF-801-WBCRT-16</b>    | <b>1.6 gpf/6.0 Lpf</b>                     |
| <b>Model AEF-801-WBCRT-35</b>    | <b>3.5 gpf/13.2 Lpf</b>                    |
| <b>Flush Mode:</b>               | <b>After Every Use</b>                     |
| <b>Manual Override:</b>          | <b>Electronic Flush Button</b>             |

## Application:

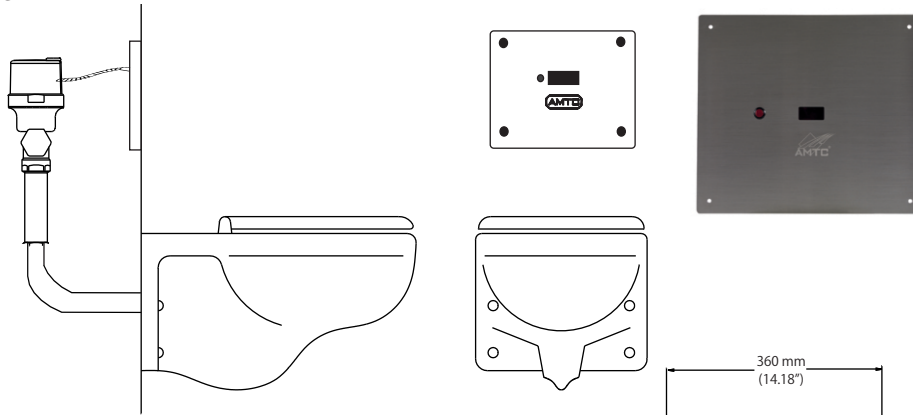

## Dimensions:

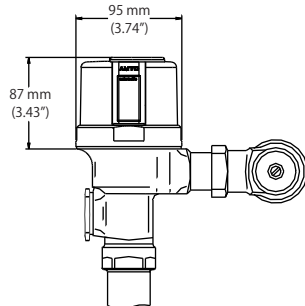

## Exploded View:

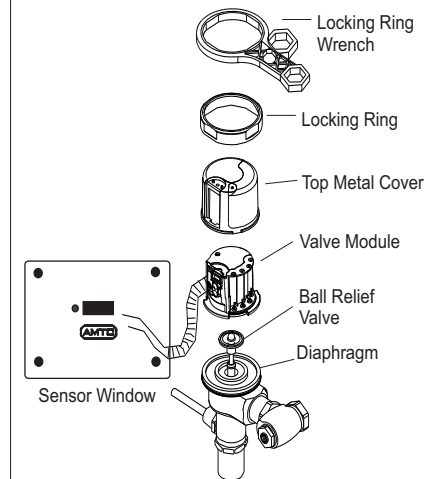

Advanced Modern Technologies Corporation • 19800 Nordhoff Place • Chatsworth, CA 91311  
Tel: (818) 883-2682 • Toll Free: (800) 874-7822 • Fax: (818) 883-2620 • [www.amtccorporation.com](http://www.amtccorporation.com)